

## Quick Start Guide

### CONTROLS & CONNECTIONS

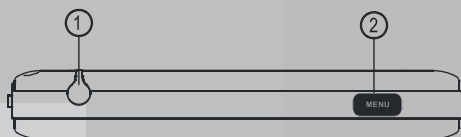

- 1. Built-in antenna
- 2. Menu

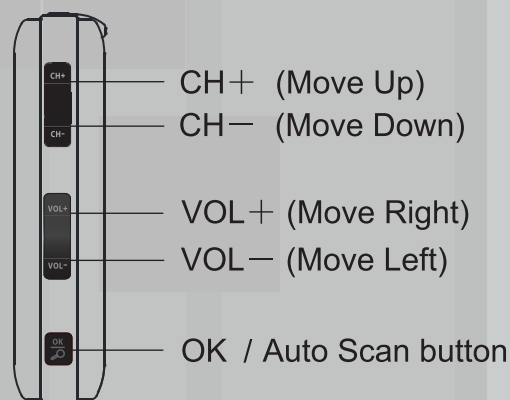
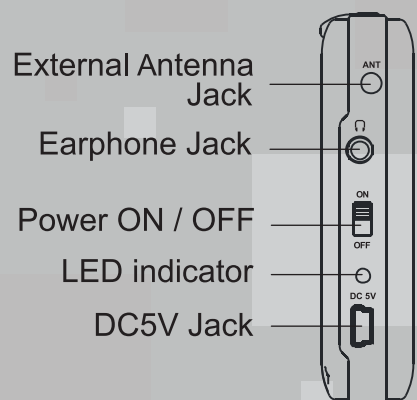
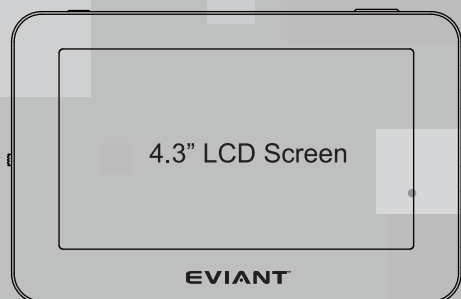

Press and hold OK button for 3 seconds to Start Auto Scan

| Status                               | LED light       |
|--------------------------------------|-----------------|
| Charging battery when power off      | Red flashing    |
| Battery fully charged when power off | Red             |
| Power on without charging            | Green           |
| Charging battery when power on       | Orange flashing |

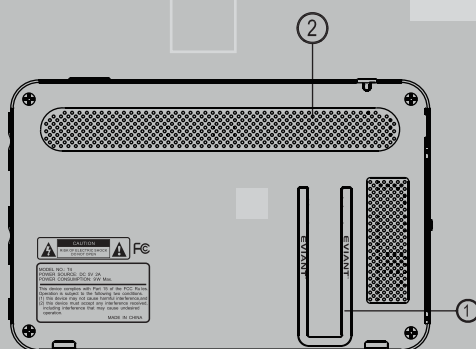

- 1. Stand
- 2. Speakers

For more detailed information regarding picture, audio, and channel options, see the User Manual.

### SETTING UP YOUR TV

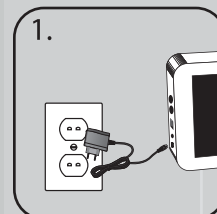

1. Connect the AC Adapter

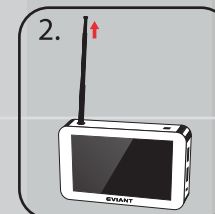

2. Extend the Antenna

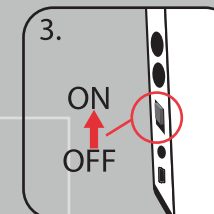

3. Turn on the Power Switch

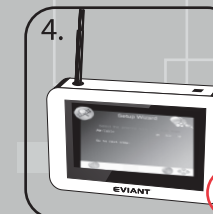

4. Press and hold OK button for 3 seconds to start Auto Scan

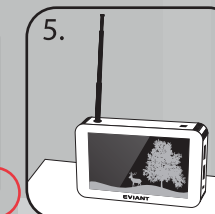

5. Place TV on a Stationary Surface

Note: Your TV comes with a built-in lithium ion rechargeable battery. Charge the battery fully before initial use. Charging time is normally 3 hours. A fully charged battery delivers about 2 hours of use.

### ACCESSORIES



4.3" Portable Digital TV

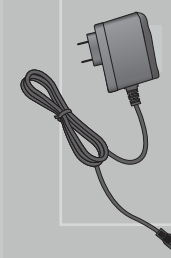

AC Adaptor

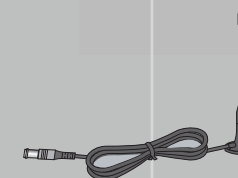

Additional External Antenna\*  
\*In order to receive stronger signal, the additional external antenna can be attached to the digital TV.

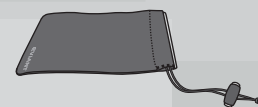

Protective Pouch

**Not for use in a car or automobile**  
**Please place in stationary location to avoid signal loss**

